

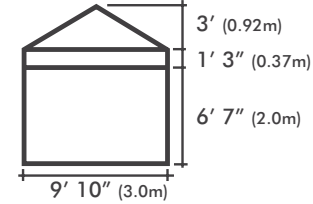

ITEM	SPECIFICATION		
Size	10 x 10' (3x3m)	10' x 15' (3x4.5m)	10' x 20' (3x6m)
Height	10' 10" (3.29m)	10' 10" (3.29m)	10' 10" (3.29m)
Clearance	6' 7" (2m)		
Frame Weight	57lb (26kg)	75lb (34kg)	104lb (47kg)
Roof Canopy Weight	13lb (6kg)	20lb (9kg)	25lb (11kg)
Main Profile	2" (50mm)		
Truss Bars	1 1/4" x 1/2" (33 x 15mm)		
Framework	Aluminum 6005/T5		
Pull Ring System	Lower		
Push Button System	Upper		
Roof Tension	Spring		
Nuts & Bolts	Stainless Steel		
Connectors	Aluminum		
Feet	Steel		
UNIQUE FEATURE	The Q8 Roof includes a universal Velcro Flap along the Front Valance for the optional accessory Printed Detachable Valance.		
Fabric	Plain 500D PVC Coated Polyester ● ● ● ● ● Printed 600D PU Coated Polyester		
Instant Canopy Includes	Tie Down Ropes, Steel Stakes & Wheeled Protective Cover		
Warranty	Frame 10 Years / Polyester Plain & Printed 1 Year		

TECHNICAL DIAGRAMS

10' x 10'



10' x 15'

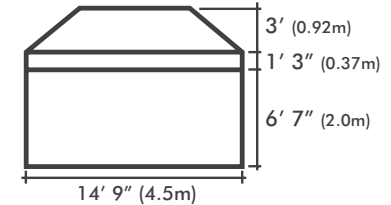

10' x 20'

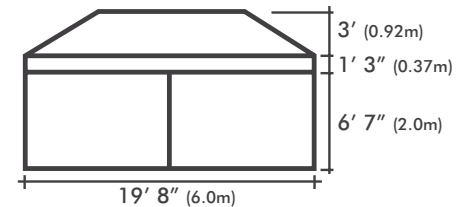

ADDITIONAL INFORMATION

The Q8 Quasar features an advanced and innovative frame geometry. The unique frame profile is the cutting edge in design and functionality. The Q8 is designed for the ultimate professional display. This canopy is a great form of portable, flexible outdoor/ indoor branding.

The Q8 professional range features a four-groove channel which provides a streamline method to attach and slide in keder tracking full and half wall panels and partitions.

FRAME DETAIL

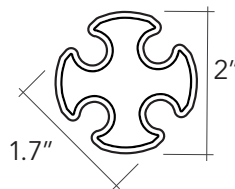

2" Frame Profile



Aluminum Connectors



Advanced Geometry Truss Bars

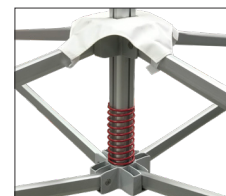

Roof Tensioning



Commercial Feet